

NSK-RA55 - Linear Guides

DIMENSIONS

Rail Part Number	Rail Dimensions (mm)							Weight (lbs)
	W ₁	H ₁	G	F	d x D x h	B ₃	Rail Length (mm)	
NSK-R1A55L-200-10-10	53	43.5	30	60	16x23x20	26.5	200	6.4
NSK-R1A55L-400-20-20	53	43.5	30	60	16x23x20	26.5	400	12.9
NSK-R1A55L-500-10-10	53	43.5	30	60	16x23x20	26.5	500	16.1
NSK-R1A55L-700-20-20	53	43.5	30	60	16x23x20	26.5	700	22.5
NSK-R1A55L-800-10-10	53	43.5	30	60	16x23x20	26.5	800	25.8
NSK-R1A55L-1000-20-20	53	43.5	30	60	16x23x20	26.5	1000	32.2
NSK-R1A55L-1100-10-10	53	43.5	30	60	16x23x20	26.5	1100	35.4
NSK-R1A55L-1300-20-20	53	43.5	30	60	16x23x20	26.5	1300	41.9
NSK-R1A55L-1400-10-10	53	43.5	30	60	16x23x20	26.5	1400	45.1
NSK-R1A55L-1600-20-20	53	43.5	30	60	16x23x20	26.5	1600	51.5
NSK-R1A55L-1700-10-10	53	43.5	30	60	16x23x20	26.5	1700	54.7
NSK-R1A55L-1900-20-20	53	43.5	30	60	16x23x20	26.5	1900	61.2
NSK-R1A55L-2000-10-10	53	43.5	30	60	16x23x20	26.5	2000	64.4
NSK-R1A55L-2200-20-20	53	43.5	30	60	16x23x20	26.5	2200	70.8
NSK-R1A55L-2300-10-10	53	43.5	30	60	16x23x20	26.5	2300	74.0
NSK-R1A55L-2500-20-20	53	43.5	30	60	16x23x20	26.5	2500	80.5
NSK-R1A55L-2600-10-10	53	43.5	30	60	16x23x20	26.5	2600	83.7
NSK-R1A55L-2800-20-20	53	43.5	30	60	16x23x20	26.5	2800	90.1
NSK-R1A55L-2900-10-10	53	43.5	30	60	16x23x20	26.5	2900	93.4
NSK-R1A55L-3100-20-20	53	43.5	30	60	16x23x20	26.5	3100	99.8
NSK-R1A55L-3200-10-10	53	43.5	30	60	16x23x20	26.5	3200	103.0
NSK-R1A55L-3400-20-20	53	43.5	30	60	16x23x20	26.5	3400	109.5
NSK-R1A55L-3500L	53	43.5	30	60	16x23x20	26.5	3500	112.7

AN, AL Square Type

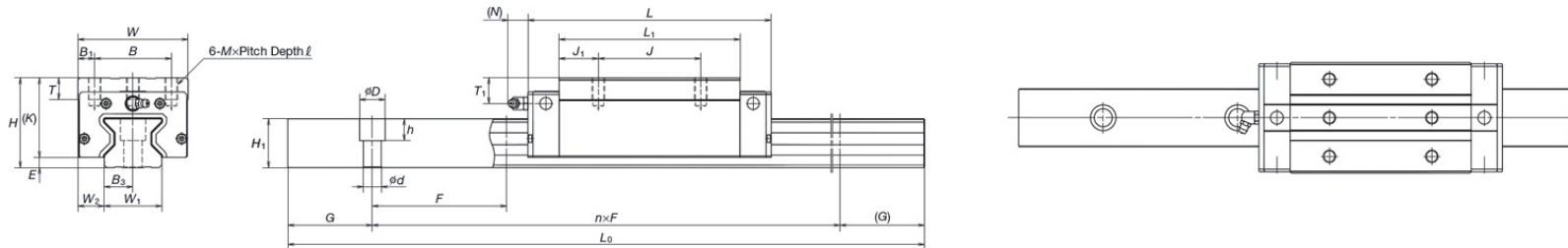

Block Part Number	Fabrication Dimension (mm)		Block Dimensions (mm)												Load Capacities (kN)		Static Moment (Nm)			Weight (lbs)
	H	W ₂	W	L	L ₁	B	B ₁	E	J ₁	T ₁	N	J	K	T	C	C ₀	M _{r0}	M _{p0}	M _{y0}	
NSK-RAA55ANP6Z	80	23.5	100	184	128	75	12.5	9	26.5	21	14	75	71	18	129	330	10200	7060	7060	10.80
NSK-RAA55ALP6Z	70	23.5	100	184	128	75	12.5	9	26.5	11	14	75	61	18	129	330	10200	7060	7060	9.04

The rated load capacities and static moment values are calculated according to the ISO Standards (ISO14728-1) for linear guides. If the above basic dynamic load rating (100km) is converted into 50km rating, use the formula:
 $C_{50km} = 1.23 \times C_{100km}$. With the RA series, the dynamic load rating is the same in both the vertical and horizontal directions (4-way load specifications).

Distributed by Anaheim Automation, Inc.
 USA Stock in Anaheim, CA
 1-800-345-9401
www.anaheimautomation.com

BN, BL, Low-Profile Type

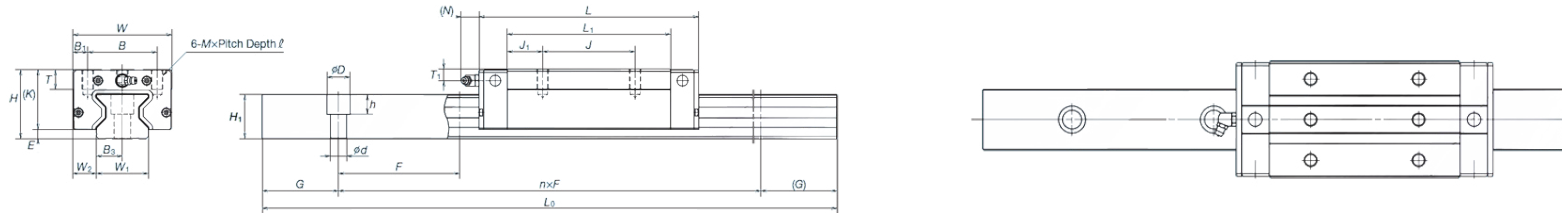

Block Part Number	Fabrication Dimension (mm)		Block Dimensions (mm)												Load Capacities (kN)		Static Moment (Nm)			Weight (lbs)
	H	W ₂	W	L	L ₁	B	B ₁	E	J ₁	T ₁	N	J	K	T	C	C _n	M _{r_n}	M _{p_n}	M _{y_n}	
NSK-RAA55BNP6Z	80	23.5	100	234	178	75	12.5	9	41.5	21	14	95	71	18	168	462	14300	13600	13600	14.77
NSK-RAA55BLP6Z	70	23.5	100	234	178	75	12.5	9	41.5	11	14	95	61	18	168	462	14300	13600	13600	12.57

EM, GM Flange Type

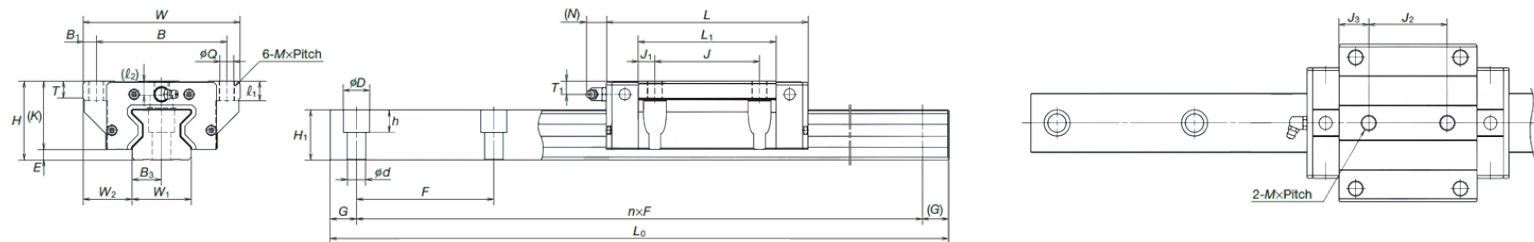

Block Part Number	Fabrication Dimension (mm)		Block Dimensions (mm)												Load Capacities (kN)		Static Moment (Nm)			Weight (lbs)
	H	W ₂	W	L	L ₁	B	B ₁	E	J ₁	T ₁	N	J	K	T	C	C _n	M _{r_n}	M _{p_n}	M _{y_n}	
NSK-RAA55EMP6Z	70	43.5	140	184	128	116	12	9	16.5	11	14	95	61	15	129	330	10200	7060	7060	11.91
NSK-RAA55GMP6Z	70	43.5	140	234	178	116	12	9	41.5	11	14	95	61	15	168	462	14300	13600	13600	16.53